

# Ground Level

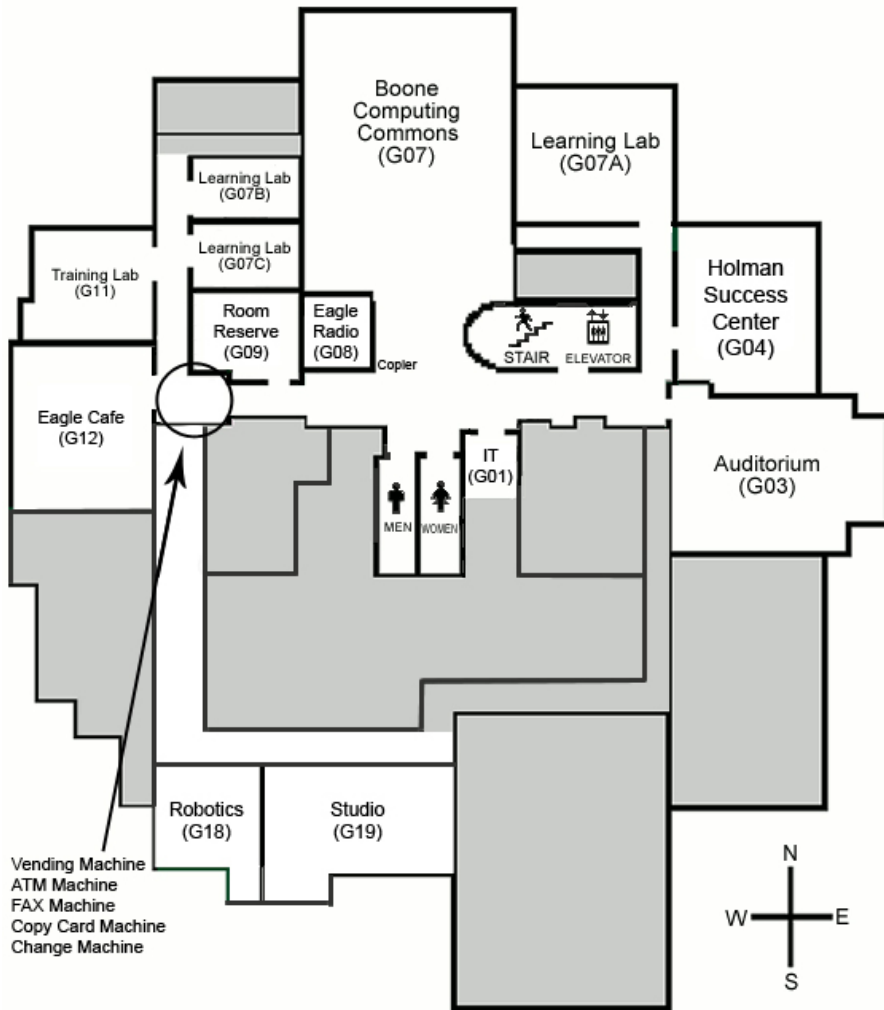

This level features:

- |                     |                       |
|---------------------|-----------------------|
| ATM                 | FAX                   |
| Auditorium          | Holman Success Center |
| Boone Computing Lab | IT Offices            |
| Change Machine      | Learning Labs         |
| Copy Card Machine   | Photocopier           |
| Eagle Cafe          | School Supplies       |
| Eagle Radio         | Vending Machine       |
|                     | Training Lab          |

# First Level

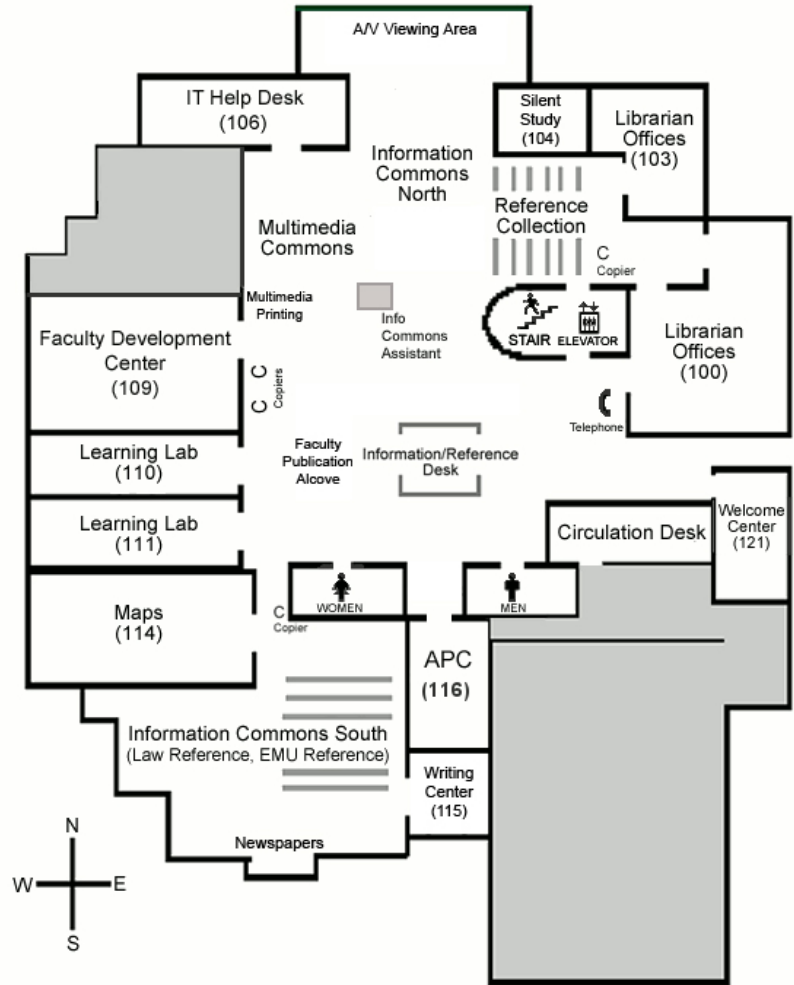

This level features:

- |                            |                      |
|----------------------------|----------------------|
| Academic Projects Center   | Multimedia Commons   |
| Circulation Desk           | Multimedia Printing  |
| Computer Help Desk         | Newspapers           |
| Faculty Development Center | Photocopiers         |
| Information Commons North  | Reference Collection |
| Information/Reference Desk | Silent Study Room    |
| Librarian Offices          | Welcome Center       |
| Maps                       | Writing Center       |

*Halle Library Building*  
**Second Level**

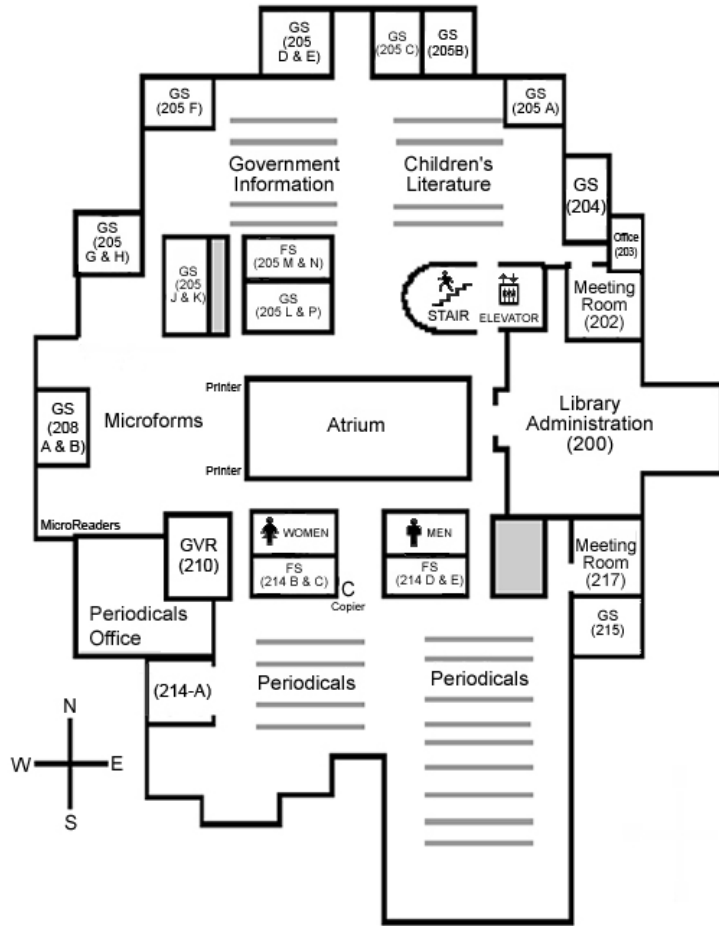

**Third Level**

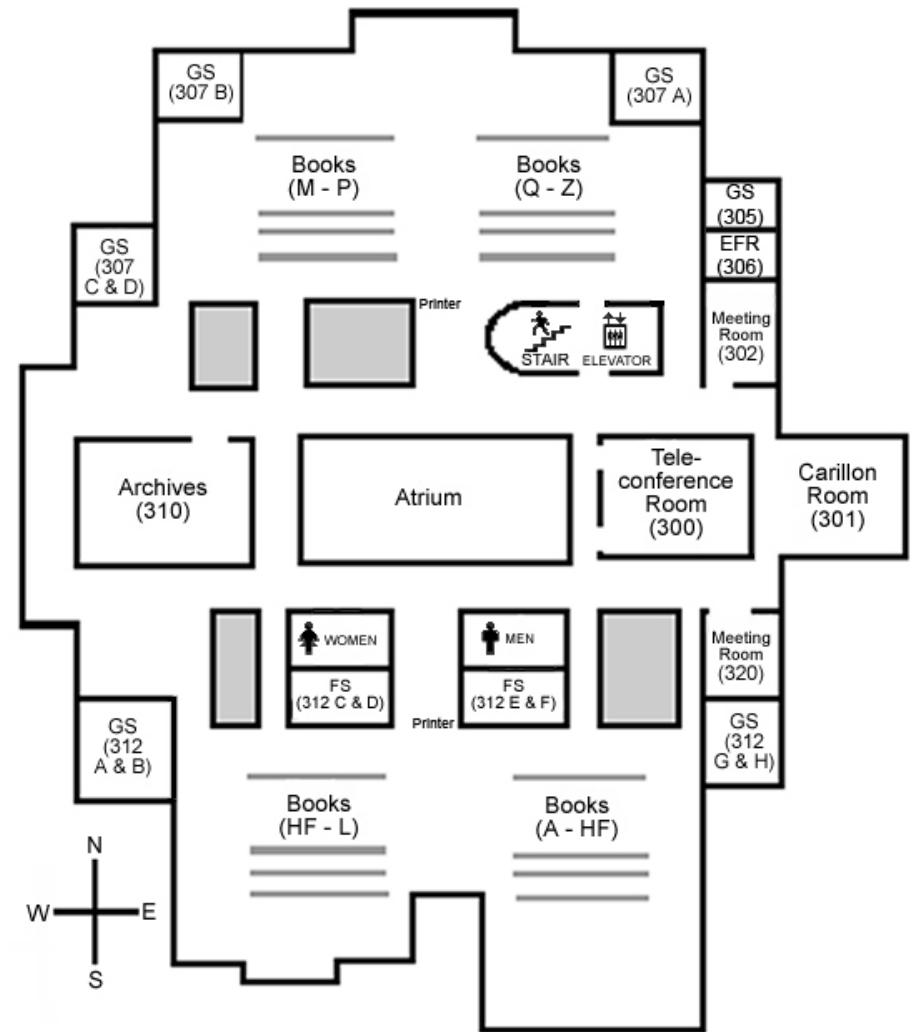

This level features:

- |                              |                          |
|------------------------------|--------------------------|
| Children's Literature        | Group Video Viewing Room |
| Children's Literature Alcove | Indexes                  |
| Classroom (214)              | Library Administration   |
| Faculty Offices              | Meeting Rooms            |
| Faculty Study Rooms          | Microforms               |
| Government Documents         | Periodicals              |
| Group Study Rooms            | Photocopier              |

This level features:

- |                     |                     |
|---------------------|---------------------|
| Book Collection     | Meeting Rooms       |
| Carillon Room       | Quiet Study Floor   |
| Faculty Study Rooms | Teleconference Room |
| Group Study Rooms   | University Archives |